

Project No:136

Project Name:GOLD NETBALL CENTRE

Document No: SCH-002

This schedule is to be read in association with the rest of the documents in the set. Any discrepancies are to be reported to the superintendent immediately.

FF&E SCHEDULE				
DATE	REV	DESCRIPTION	PREPARED	REVIEWED
26.03.25	A	ISSUE FOR REVIEW	TA	YN
07.04.25	B	ISSUE FOR REVIEW		

Note: Revisions in RED TEXT.

GOLD NETBALL CENTRE FF&E SCHEDULE						
CODE	DESCRIPTION	IMAGE	SUPPLIER	QTY.	COMMENTS	REV
LC-01	<b>LOCKERS</b> Cubiloc Locker Specification: 1 Door with shoe box Lock: <b>Keypad</b> Finish: LM-01		<b>Cubispec</b> Jon Craddock E:jon@cubispec.com.au M: 0437 440 360			<b>B</b>
RD-01	<b>ROLLER DOOR</b> Super Glide RDO Colour: Shale Grey		<b>Gryphon Garage Doors</b> Sarah Davey E:sarah@gryphongaragedoors.com.au M: 0409 005 370			<b>B</b>

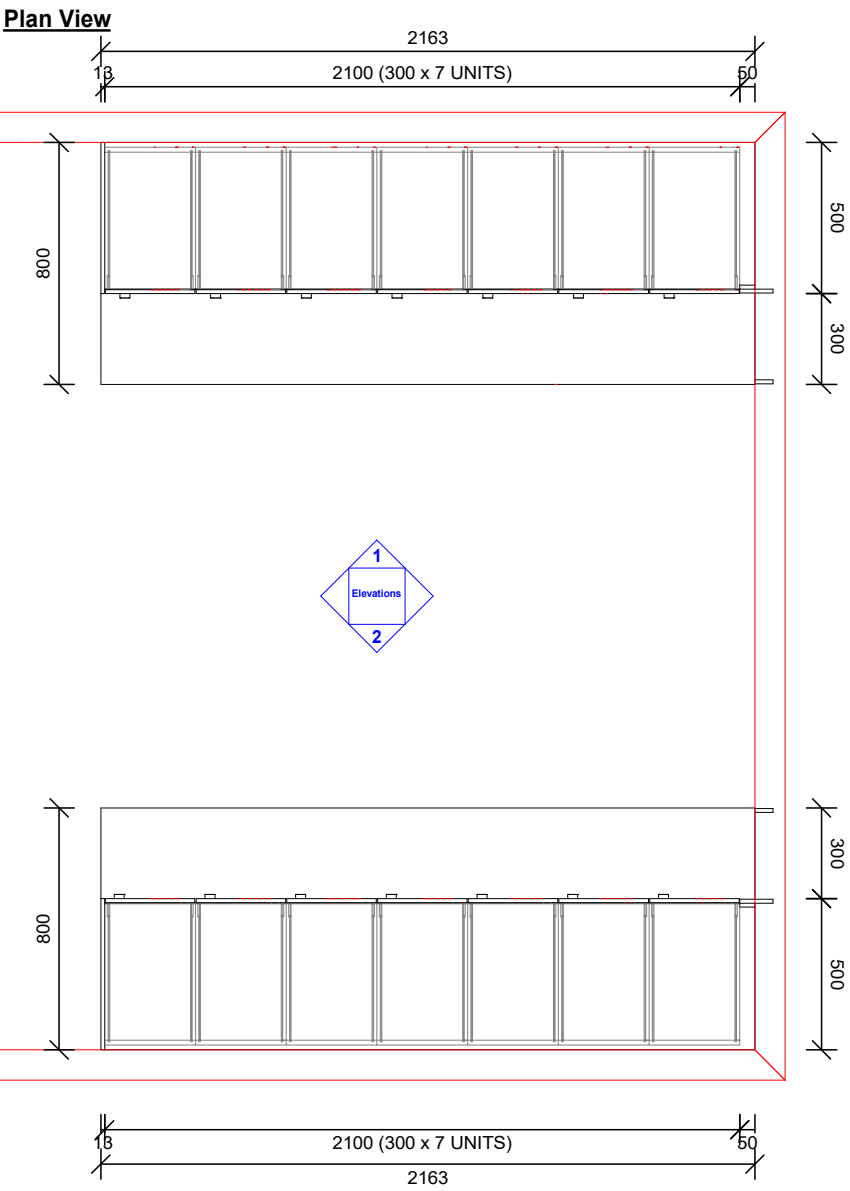

Elevation View 1

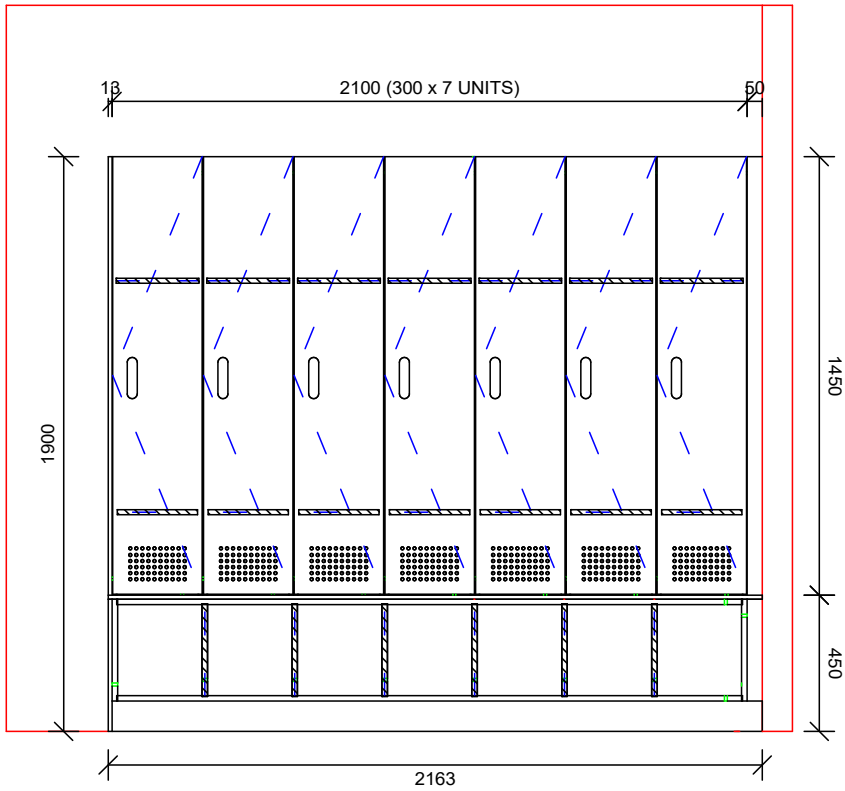

Elevation View 2

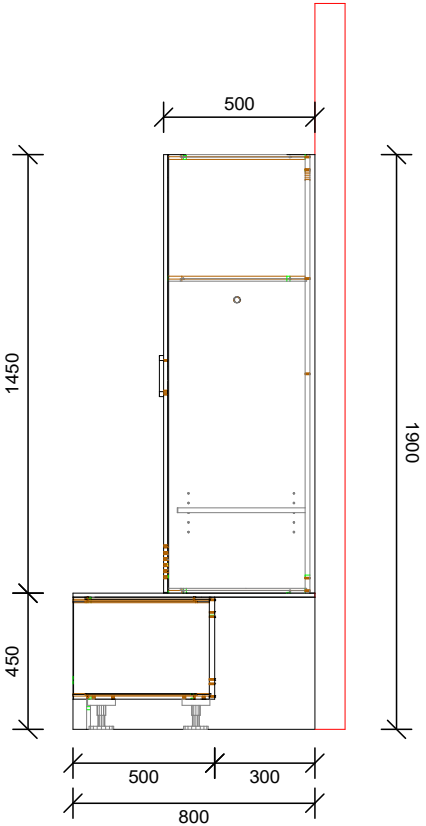
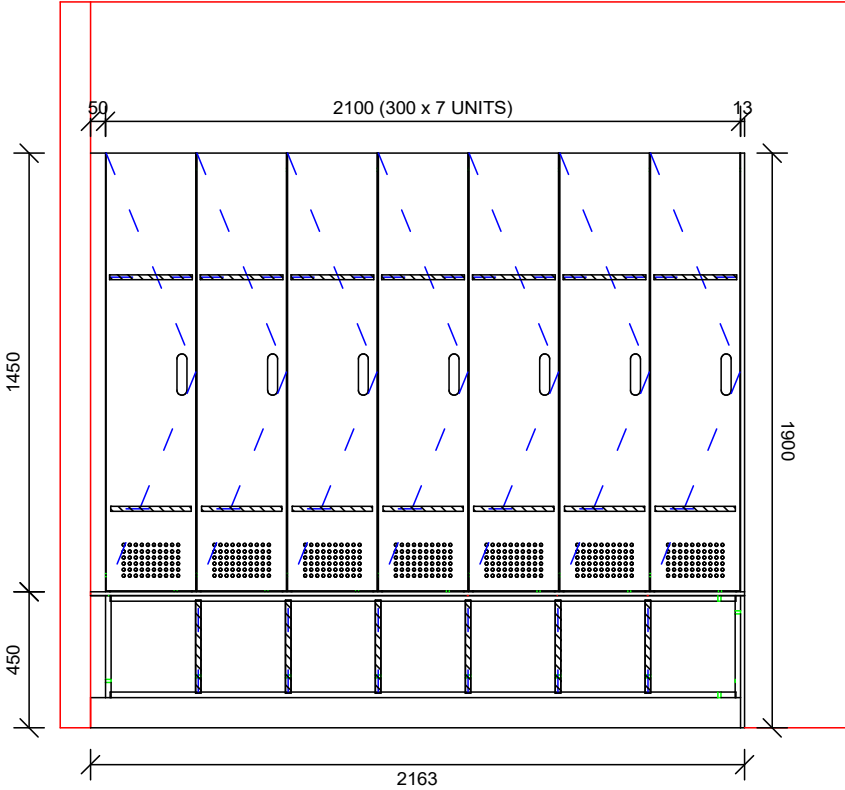

Plan View

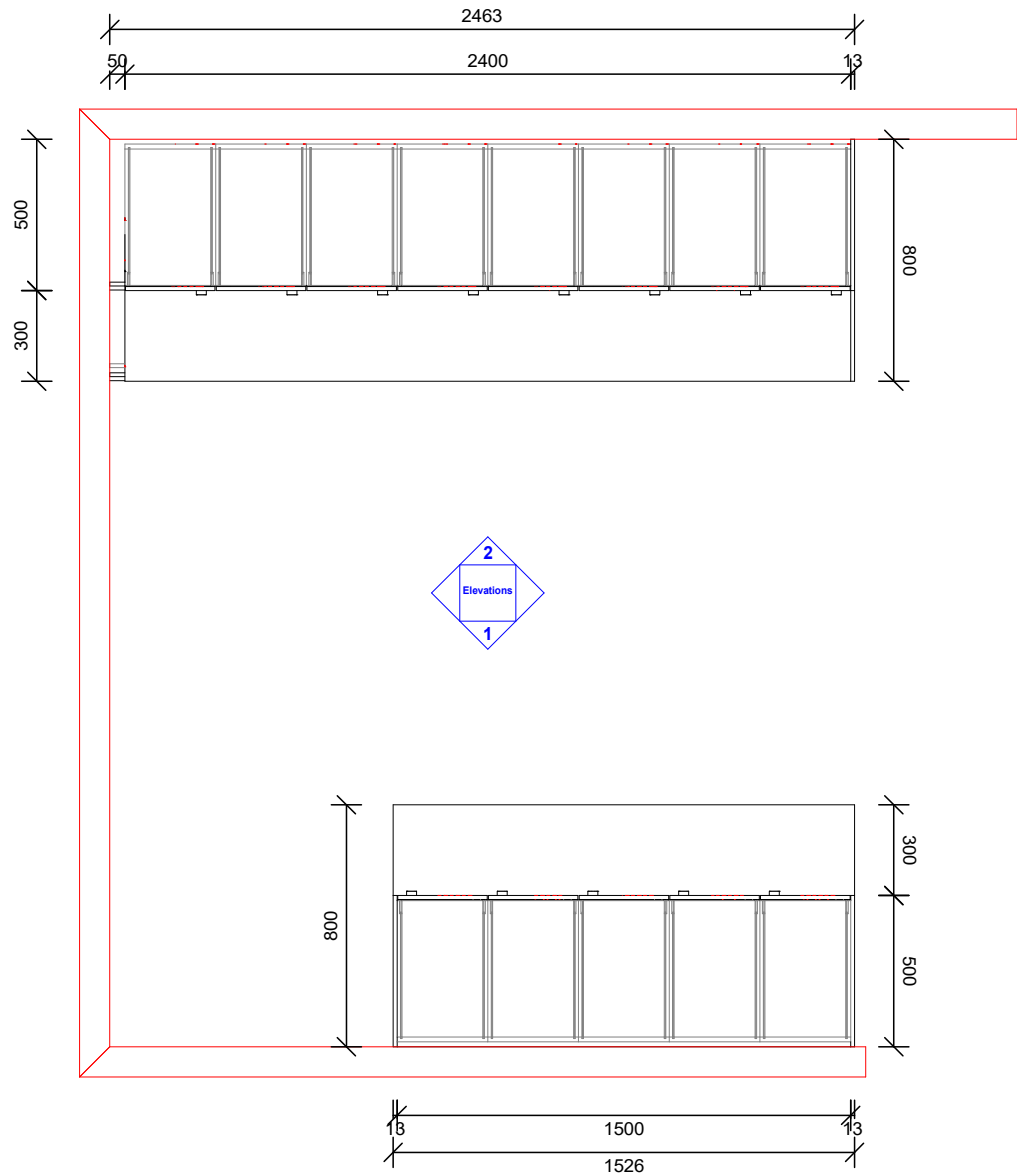

Elevation View 1

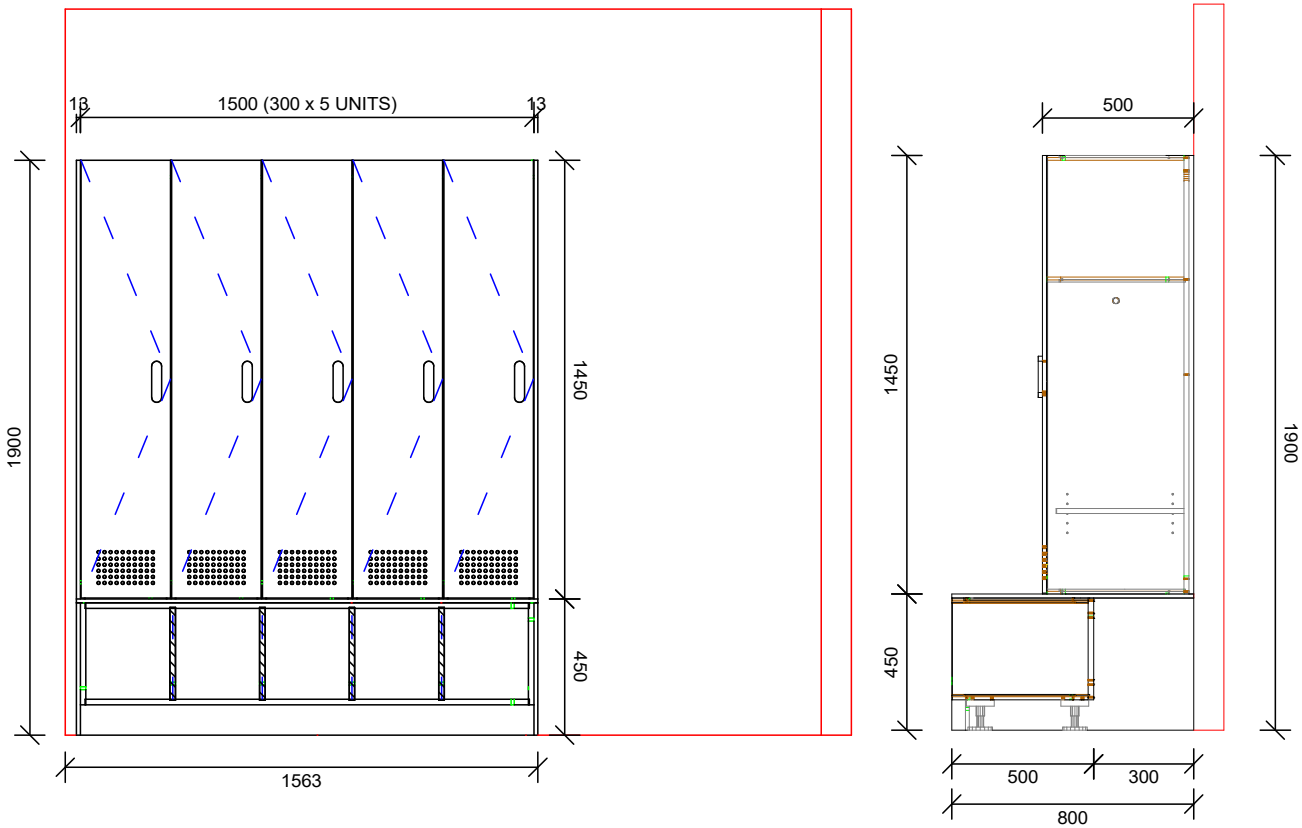

Elevation View 2

